

PCB Piezotronics Inc. claims proprietary rights in the information disclosed hereon. Neither it nor any reproduction thereof will be disclosed to others without the written consent of PCB Piezotronics Inc.

9137

REVISIONS		
REV	DESCRIPTION	DIN
D	REMOVED TEDS OPTION	55186

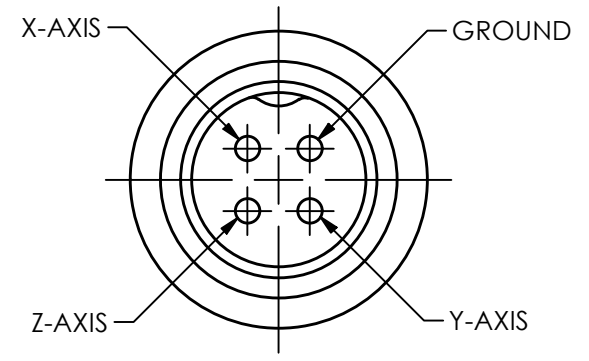
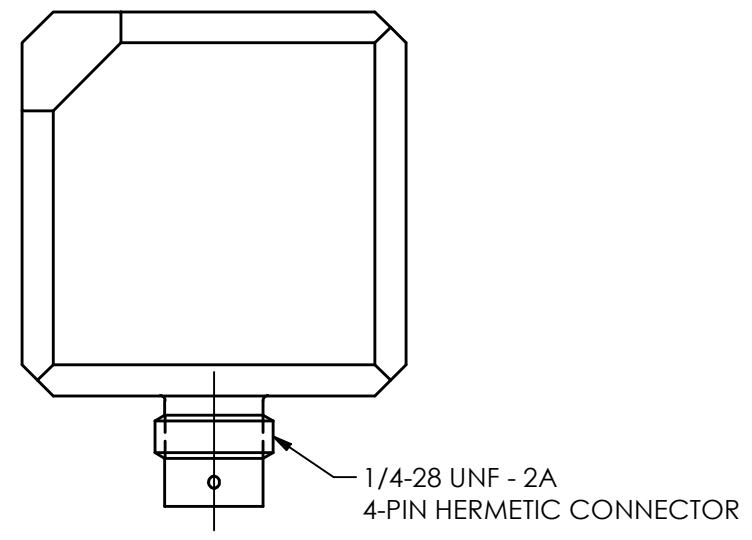

**CONNECTOR PIN DESIGNATION**  
SCALE: 5X

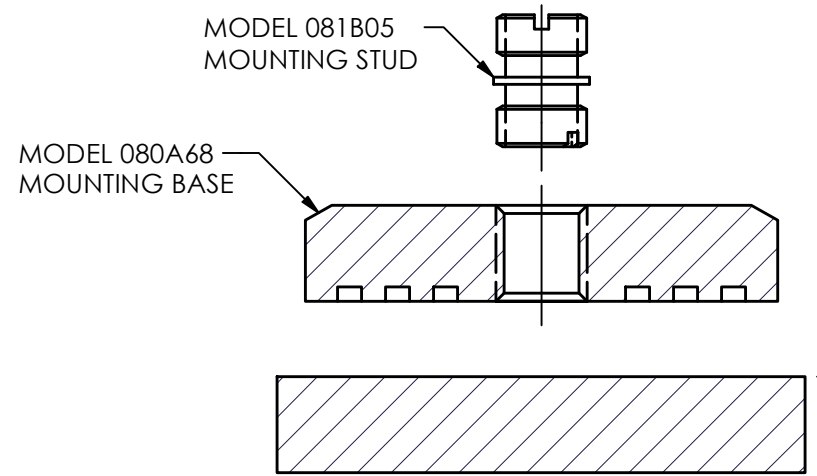
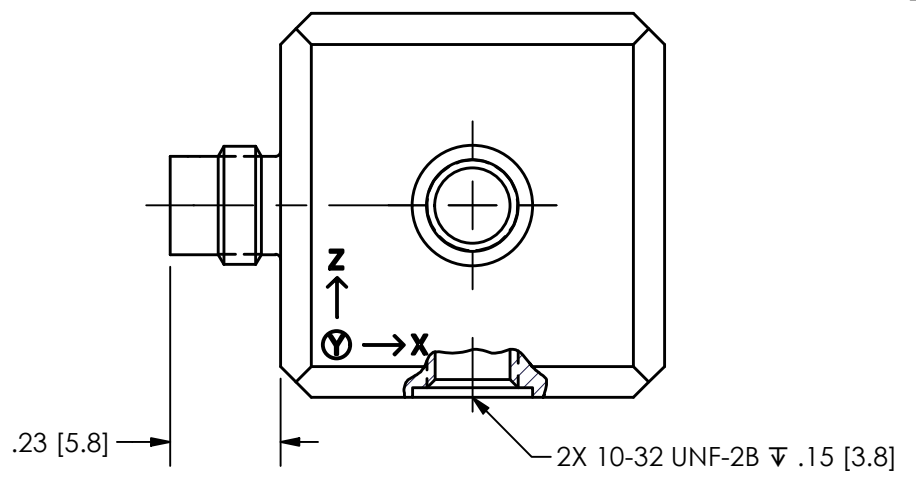
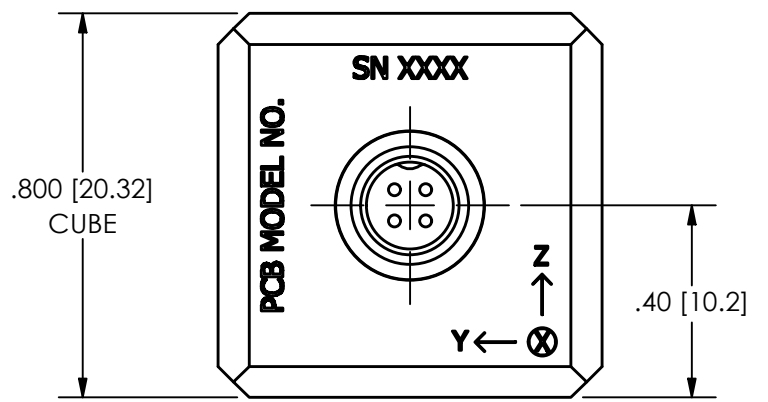

3.) FOR SEMI-PERMANENT MOUNTING USE QUICK BONDER (080A90) OR EQUIVALENT

2.) FOR TEMPORARY MOUNTING APPLICATIONS, USE PETRO WAX (MODEL 080A109) APPLY APPROXIMATELY 10 POUNDS [45 NEWTONS] OF FORCE TO TOP OF ACCELEROMETER CREATING A THIN BUT HOMOGENEOUS LAYER OF WAX

1. RECOMMENDED MOUNTING SURFACE SHOULD BE FLAT TO WITHIN .003 [.08] TIR OVER \u22051.100 [27.94] WITH A 32 [.8] FINISH FOR BEST RESULTS

UNLESS OTHERWISE SPECIFIED TOLERANCES ARE:		DRAWN		CHECKED		ENGINEER		PCB PIEZOTRONICS			
DIMENSIONS IN INCHES		AME		12/30/24		JDM		12/30/24		SDS	
DECIMALS	XX \u00b1.01 XXX \u00b1.005	DIMENSIONS IN MILLIMETERS [IN BRACKETS]		DECIMALS		X \u00b10.3 XX \u00b10.13		ANGLES \u00b1 2 DEGREES		TITLE	
CABLE TOLERANCES IN ENGLISH		CABLE TOLERANCES IN METRIC		INSTALLATION DRAWING .8 CUBE W/ 1/4-28 4-PIN CONNECTOR TRIAXIAL ACCELEROMETER		CODE IDENT. NO. <b>52681</b>		SIZE <b>B</b>		DWG. NO. <b>9137</b>	
1" \u2264 LENGTH < 1'	= +1' / - 0	2.54cm \u2264 LENGTH < 30.5cm	= +2.54cm / - 0								
1' \u2264 LENGTH < 5'	= +2" / - 0	30.5cm \u2264 LENGTH < 1.5m	= +5.1cm / - 0								
5' \u2264 LENGTH < 100'	= +6" / - 0	1.5m \u2264 LENGTH < 30.5m	= +15.2cm / - 0								
100' \u2264 LENGTH	= +1' / - 0	30.5m \u2264 LENGTH	= +30.5cm / - 0	SCALE: 2.5X		SHEET 1 OF 1					
FILLETS AND RADII .003 - .005		FILLETS AND RADII 0.07 - 0.13									